

living to kitchen

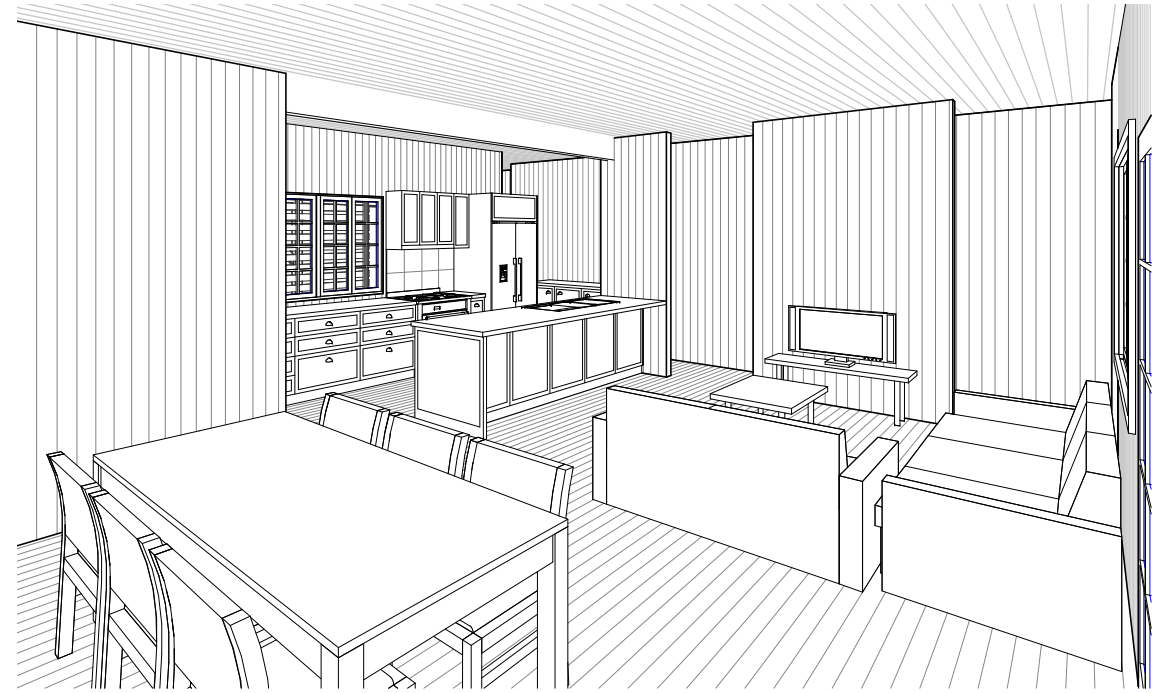

dining to kitchen

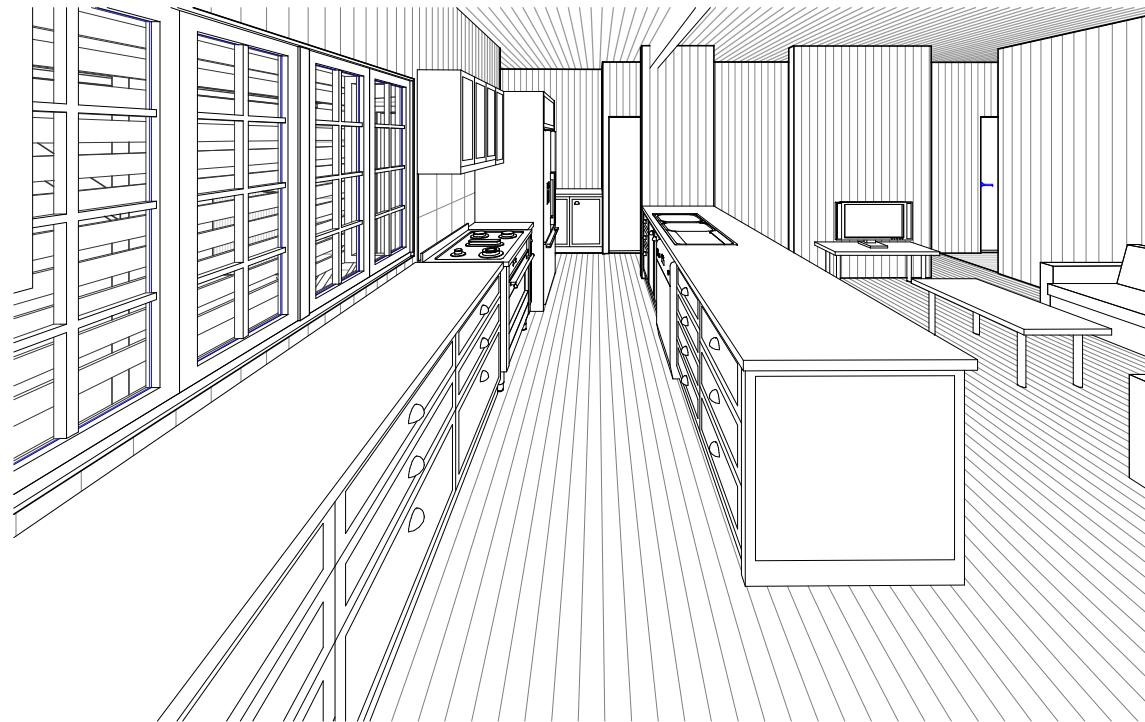

pantry to kitchen

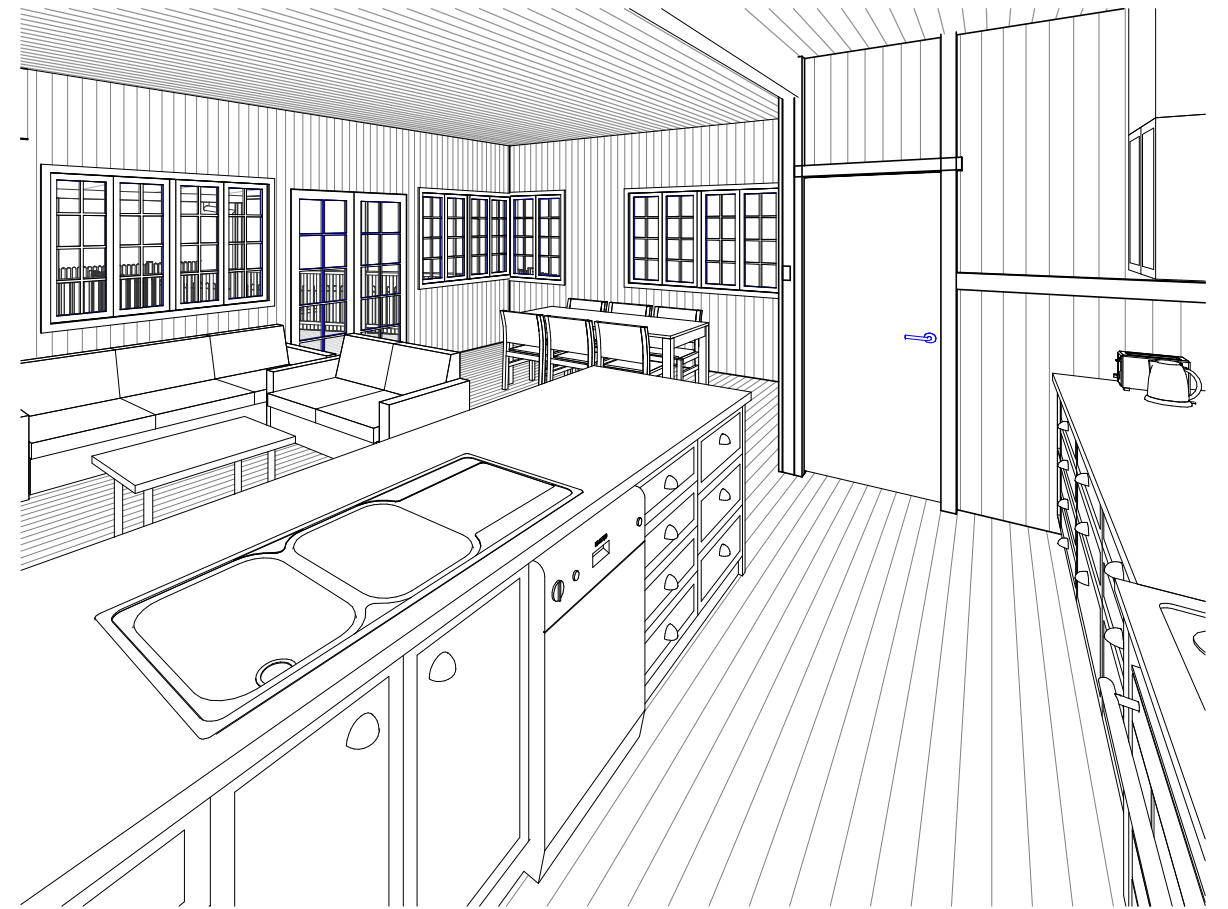

fridge to dining

**FOR CONSTRUCTION**

**Latemore Design Pty Ltd**  
 59 Cherside St  
 Grange Qld 4051  
 07 3356 9051  
 QBCC 1055247  
 ABN 39 010 895 682  
 info@latemoredesign.com.au  
 www.latemoredesign.com.au

Issue	Date	Issue	Rev	Date	Revision Description
WD04	11.02.19	WD final extra			
WD03	01.10.18	WD final			
WD02	21.07.18	WD revised			
WD01	09.07.18	Working Drawings			
DD01	04.11.17	Design Development			
SK02	08.09.17	Sk Des - House			

Scale at **Renovations**

Designed pbl  
 Drawn PBL  
 Checked pbl

at Decent St  
 Nice Suburb  
 for Great Clients

**Internal Perspectives**

Working Drawings

Job  
**2016070**  
 Dwg  
**433PD**  
 Issu  
**WD04**

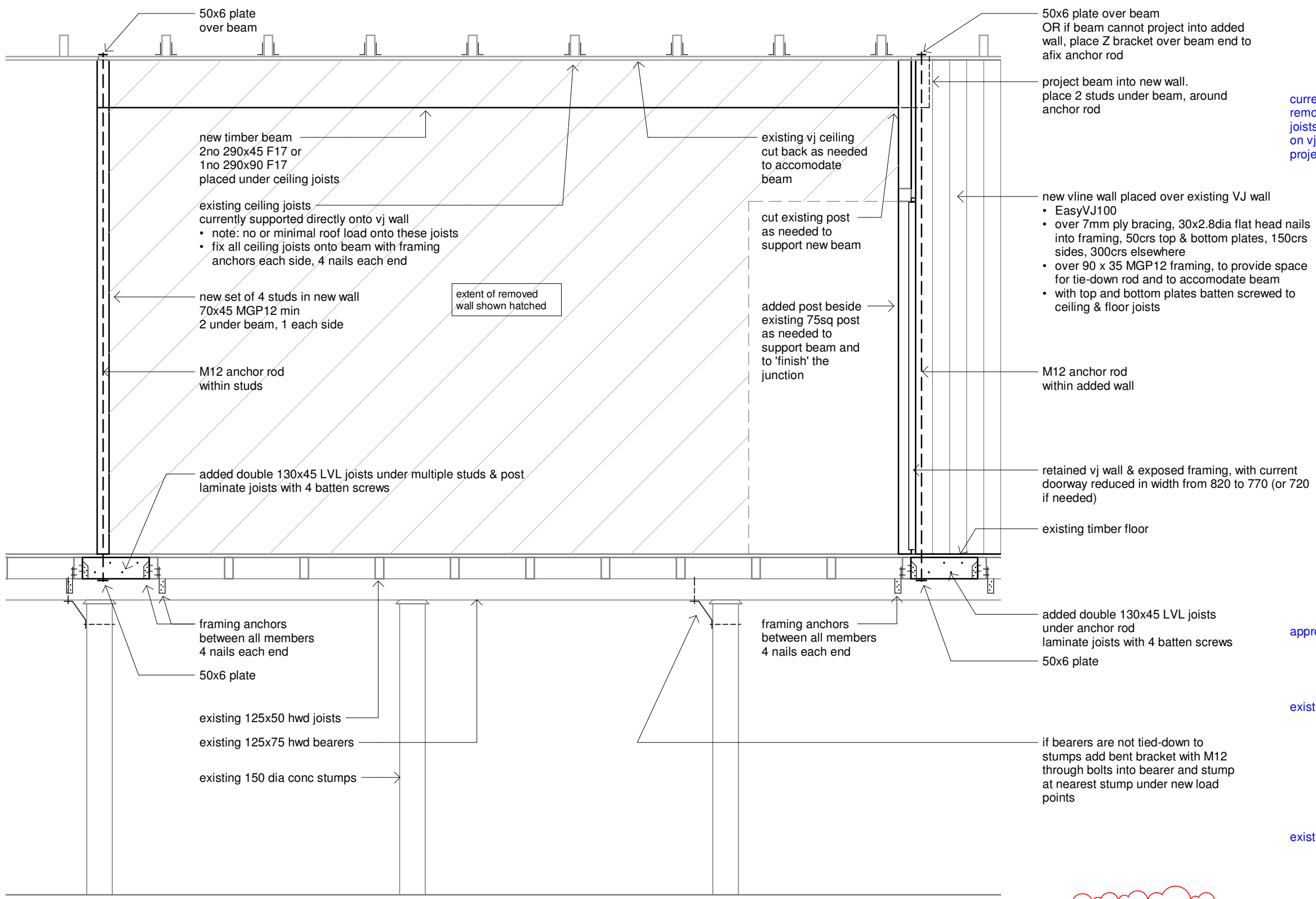

current wall to be removed. note the ceiling joists supported directly on vj boards, with others projecting into roof space



current roof space over proposed beam



close-up of wall/ceiling joists

approx line of wall over  
existing 125x50 joists  
existing 125x75 bearer



close-up of bearer under wall

changes to pantry zone

# 1 detail section of kitchen beam

1 : 25

**Latemore Design Pty Ltd**

59 Chermide St  
Grange Qld 4051

07 3356 9051

QBCC 1055247  
ABN 39 010 895 682

info@latemoredesign.com.au  
www.latemoredesign.com.au

WD04	11.02.19	WD final extra	1	31.05.19	kitchen beam changes
Issue	Date	Issue	Rev	Date	Revision Description

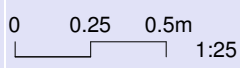

Scale at  
1 : 25

Designed  
Designer  
Drawn  
Author  
Checked  
Checker

**Renovations**

at Decent St  
Nice Suburb  
for Great Clients

**Kitchen Beam**

Working Drawings

Job  
**2016070**

Dwg  
**522FT**

Issu  
**WD04**

**FOR CONSTRUCTION**





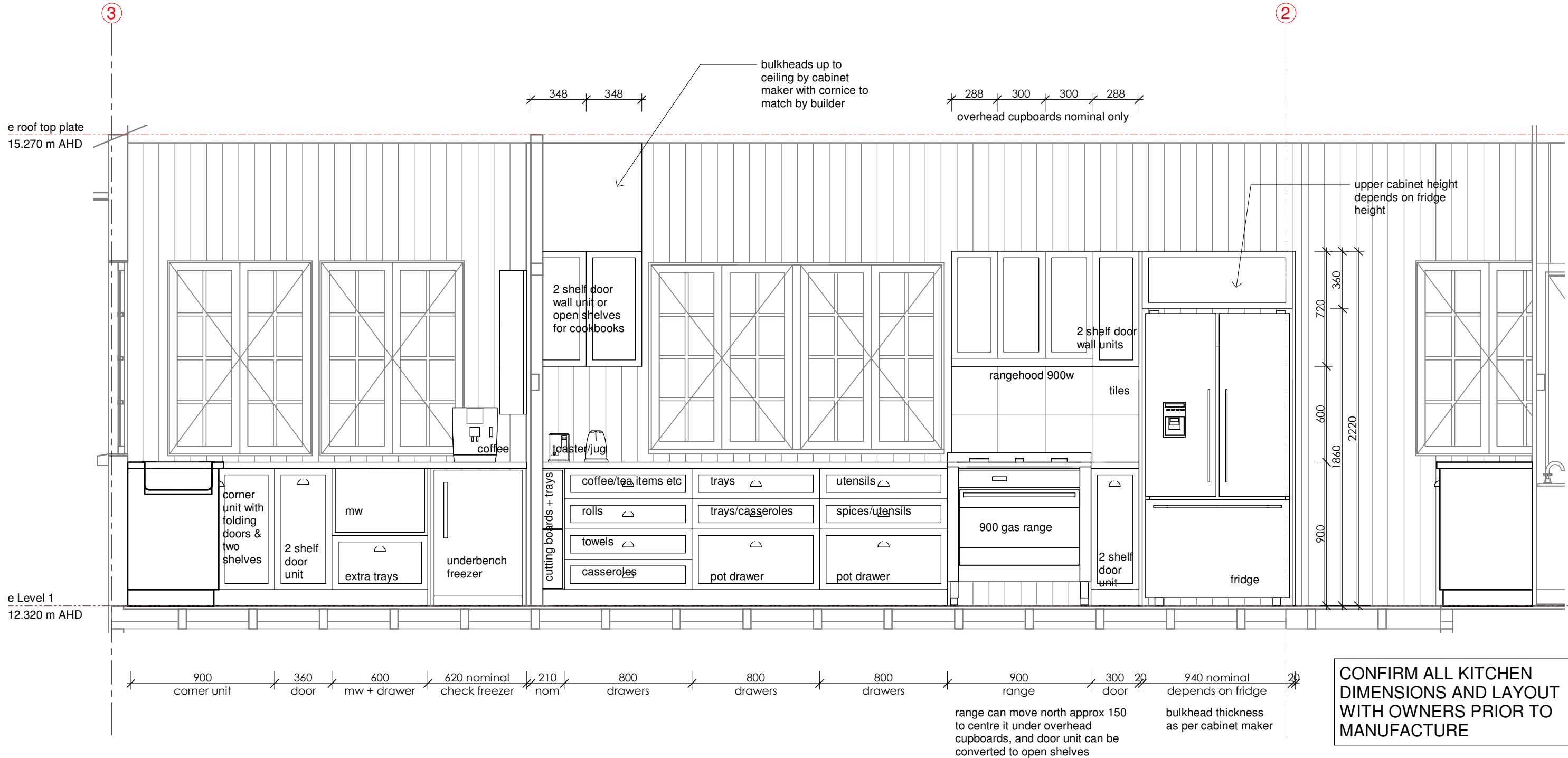

**K2** proposed section thru pantry/kitchen looking west - Callout 1  
303ST 1 : 25

**FOR CONSTRUCTION**

**Latemore Design Pty Ltd**  
 59 Chermide St  
 Grange Qld 4051  
 07 3356 9051  
 QBCC 1055247  
 ABN 39 010 895 682  
 info@latemoredesign.com.au  
 www.latemoredesign.com.au

Issue Date	Issue	Rev	Date	Revision Description
11.02.19	WD final extra	WD04		
01.10.18	WD final	WD03		
21.07.18	WD revised	WD02		
09.07.18	Working Drawings	WD01		
04.11.17	Design Development	DD01		

Scale at 1 : 25

0 200 400mm 1:20

Designed pbl  
 Drawn PBL  
 Checked pbl

**Renovations**  
 at Decent St  
 Nice Suburb  
 for Great Clients

**Details - Kitchen**  
**West Side**  
 Working Drawings

Job  
**2016070**  
 Dwg  
**651DK**  
 Issu  
**WD04**

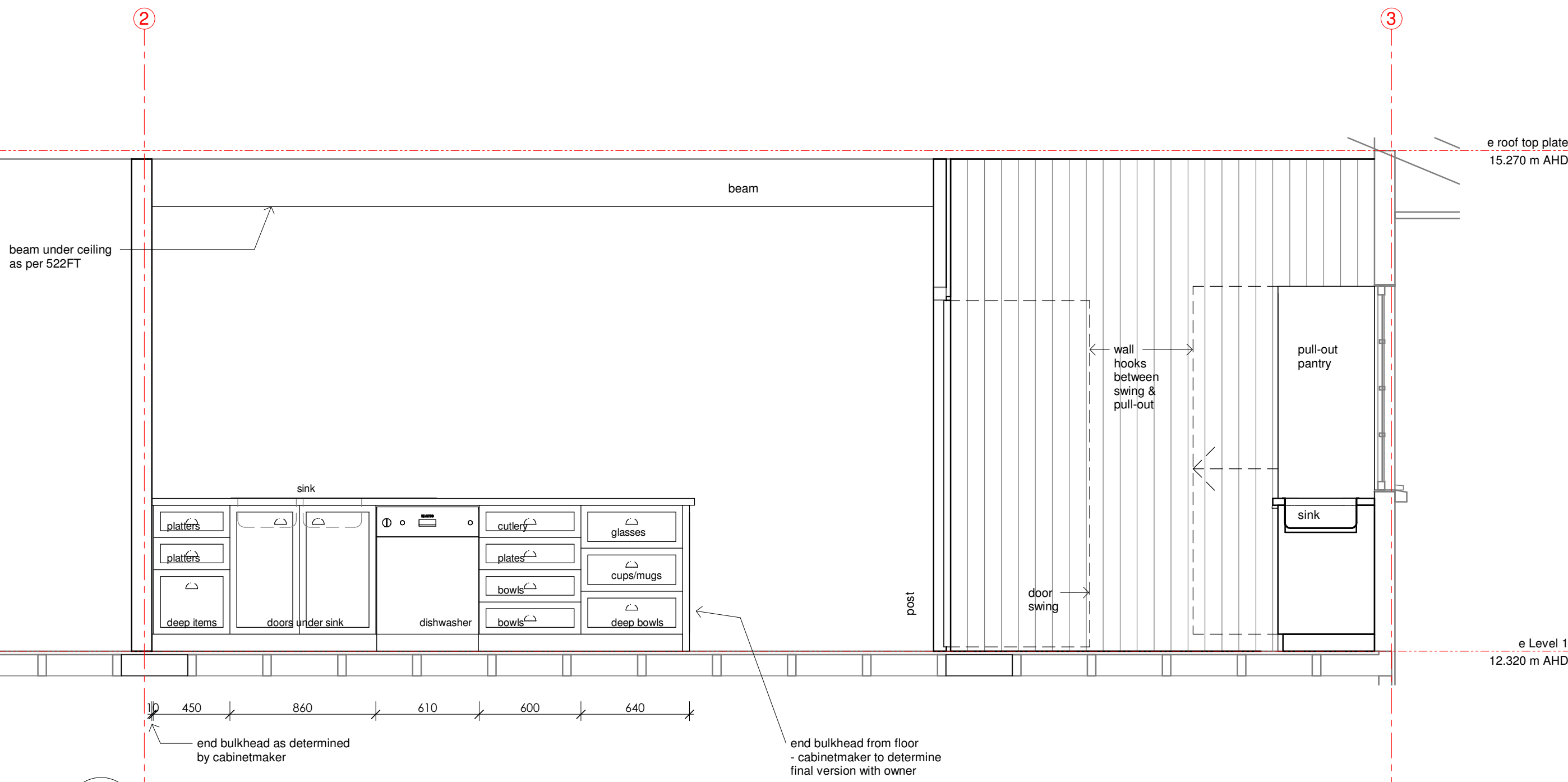

**K3** proposed section thru pantry/kitchen looking east - Callout 1  
 303ST 1 : 25

**FOR CONSTRUCTION**

**Latemore Design Pty Ltd**  
 ©  
 59 Chermide St  
 Grange Qld 4051  
 07 3356 9051  
 QBCC 1055247  
 ABN 39 010 895 682  
 info@latemoredesign.com.au  
 www.latemoredesign.com.au

Issue	Date	Issue	Rev	Date	Revision Description
WD04	11.02.19	WD final extra			
WD03	01.10.18	WD final			
WD02	21.07.18	WD revised			
WD01	09.07.18	Working Drawings			
DD01	04.11.17	Design Development			

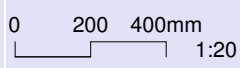

Scale at  
1 : 25  
  
 Designed  
pbl  
 Drawn  
PBL  
 Checked  
pbl

**Renovations**  
  
 at Decent St  
 Nice Suburb  
 for Great Clients

**Details - Kitchen**  
  
**East Side**  
  
 Working Drawings

Job  
**2016070**  
 Dwg  
**652DK**  
 Issu  
**WD04**

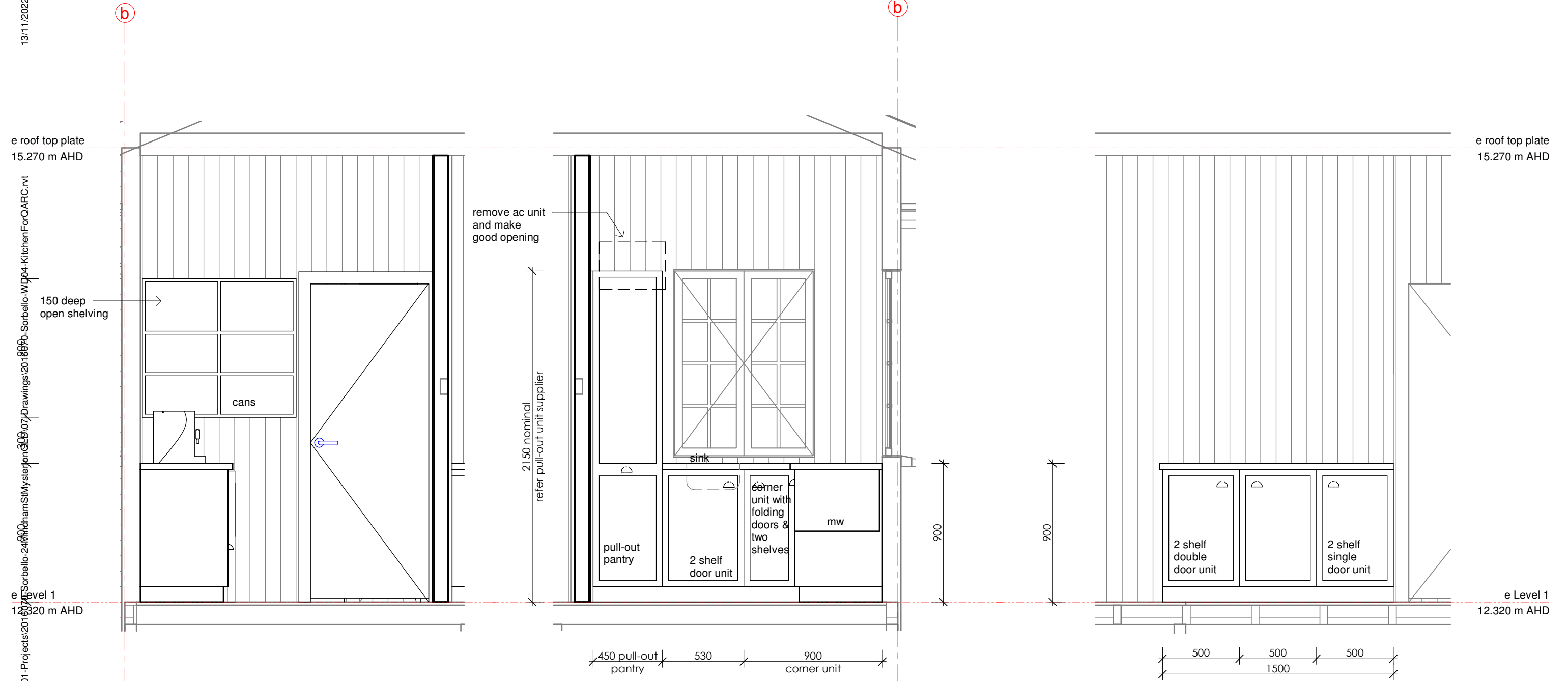

**K4** pantry callout - looking north  
321ST 1 : 25

**K5** pantry callout - looking south  
321ST 1 : 25

**K6** north kitchen callout  
321ST 1 : 25

changes to pantry zone

**FOR CONSTRUCTION**

**Latimore Design Pty Ltd**  
 59 Chermide St  
 Grange Qld 4051  
 07 3356 9051  
 QBCC 1055247  
 ABN 39 010 895 682  
 info@latimoredesign.com.au  
 www.latimoredesign.com.au

Rev	Date	Revision Description
1	31.05.19	kitchen beam changes
WD04	11.02.19	WD final extra
WD03	01.10.18	WD final
WD02	21.07.18	WD revised
WD01	09.07.18	Working Drawings
DD01	04.11.17	Design Development

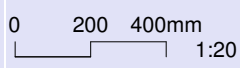

Scale at  
1 : 25

Designed  
pbl

Drawn  
PBL

Checked  
pbl

**Renovations**

at Decent St  
Nice Suburb  
for Great Clients

**Details - Kitchen**

**Pantry**

Working Drawings

Job  
**2016070**

Dwg  
**653DK**

Issu  
**WD04**

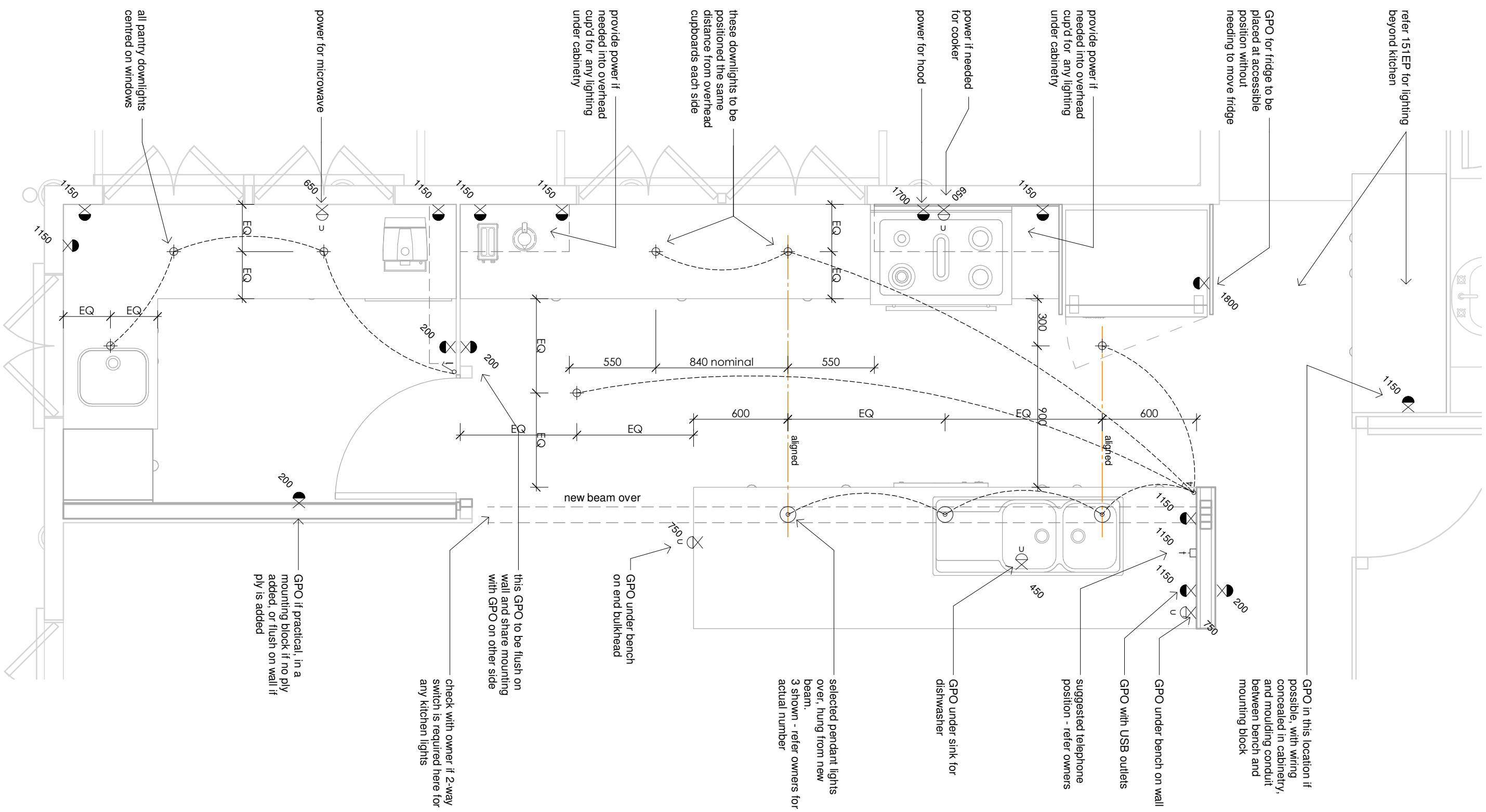

**GPO heights**  
heights shown are nominal and require confirmation with owners

**Conduits**  
if any wiring is placed on single skin VJ walls, the conduit is to be a U shaped timber cover strip, similar to image at right.



**electrics + services legend**

- |                    |                                 |                                      |
|--------------------|---------------------------------|--------------------------------------|
| <b>lighting</b>    | <b>power</b>                    | <b>sockets</b>                       |
| ⊕ downlight direct | ● GPO - double                  | ⊕ telephone point                    |
| ○ pendant light    | ⊗ GPO - single                  | <b>switches</b>                      |
|                    | ⊗ GPO - underbench (double uno) | ⌚ light switch (with no of switches) |

- notes**
- confirm position of items with owner/principal.
  - uno - switches at 1150 above finished floor and outlets and sockets at 200 above finished floor.
  - fans placed centre of rooms, with sufficient support framing.
  - provide power to all fixed & movable appliances.

**FOR CONSTRUCTION**

**Latmore Design Pty Ltd**  
 59 Chermide St  
 Grange Qld 4051  
 07 3356 9051  
 QBCC 1055247  
 ABN 39 010 895 682  
 info@latmoredesign.com.au  
 www.latmoredesign.com.au

Rev	Date	Revision Description
WD04	11.02.19	WD final extra
WD03	01.10.18	WD final
Issue Date	Issue	

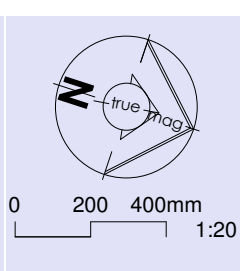

Scale at 1 : 25  
 Designed pbl  
 Drawn PBL  
 Checked pbl

**Renovations**  
 at Decent St  
 Nice Suburb  
 for Great Clients

**Details - Kitchen**  
**Electrics**  
 Working Drawings

Job **2016070**  
 Dwg **655EP**  
 Issu **WD04**